



 paulwallace

The Canadas, Turnford, EN10 6DP |  
£379,995 | Freehold



## The Canadas, Turnford, EN10 6DP

This recently refurbished TWO BEDROOM mid terraced property set in the heart of TURNFORD is BEAUTIFULLY PRESENTED THROUGHOUT and benefits from full OPEN PLAN LIVING downstairs, a refitted FAMILY BATHROOM and a low maintenance SOUTH FACING REAR GARDEN. With allocated parking to the rear, gas central heating and double-glazed windows. Situated with just a short walk to local amenities and is perfectly located for both the A10 and M25.

### Key features

- Beautifully Presented
- Mid Terraced
- Refitted Bathroom
- Allocated Parking To Rear
- Two Bedrooms
- Open Plan Living
- South Facing Garden
- Recently Refurbished

### Property Information

Tenure

Freehold

Council Tax

C

EPC Rating

C

Local Authority

Broxbourne Borough Council



**Paul Wallace Estate Agents**  
Brookfield Centre  
Cheshunt  
Hertfordshire  
EN8 0NN



01992 781100



cheshunt@paulwallace.co.uk



www.paulwallace.co.uk



Opening Times

Mon - Fri	9 am to 6:30 pm
Sat	9 am to 5:30 pm
Sun	Closed
Bank Hols	Closed

**paulwallace**  
estate agents

Cheshunts leading estate agent.  
Please get in touch for your free  
property valuation.











GROUND FLOOR  
294 sq.ft. (27.4 sq.m.) approx.

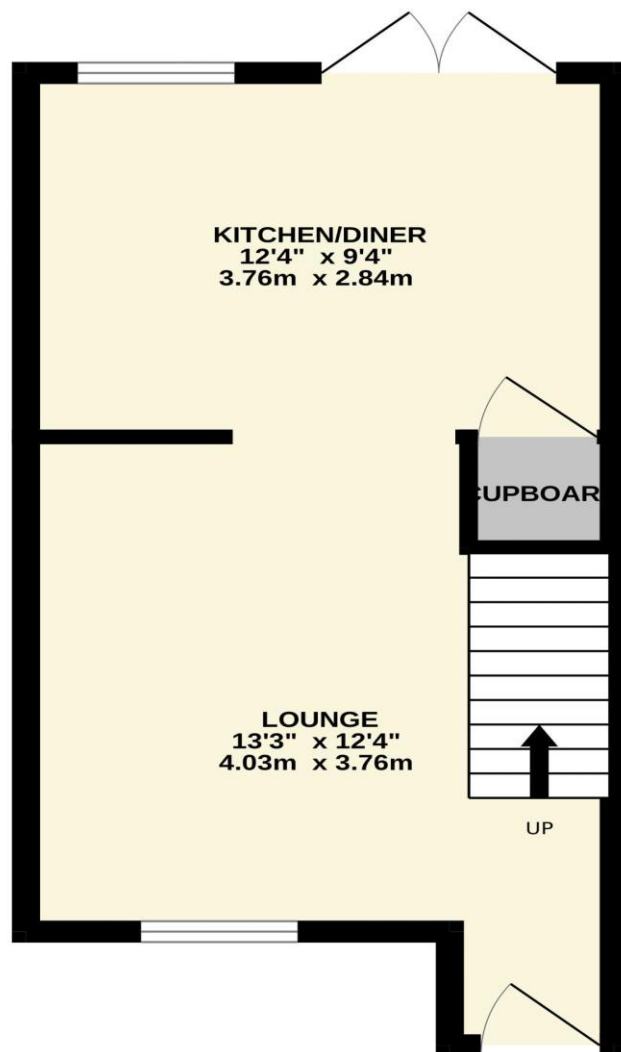

1ST FLOOR  
284 sq.ft. (26.4 sq.m.) approx.

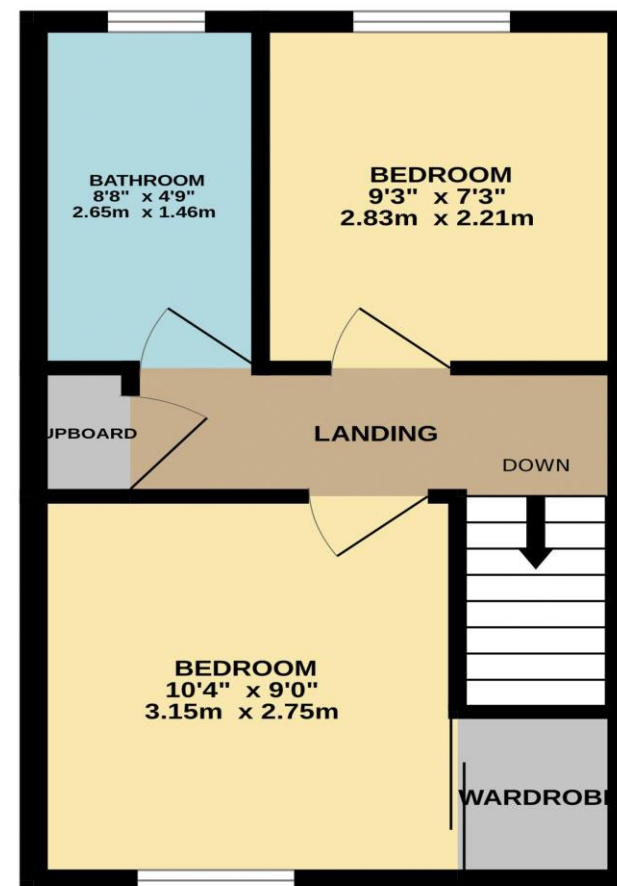

TOTAL FLOOR AREA : 578 sq.ft. (53.7 sq.m.) approx.

Whilst every attempt has been made to ensure the accuracy of the floorplan contained here, measurements of doors, windows, rooms and any other items are approximate and no responsibility is taken for any error, omission or mis-statement. This plan is for illustrative purposes only and should be used as such by any prospective purchaser. The services, systems and appliances shown have not been tested and no guarantee as to their operability or efficiency can be given.  
Made with Metropix ©2026



